

**THE PROJECT**

This study focused on developing a rationale and strategy for the provision of significant additional space for this highly integrated school. The plan was coordinated with the College's campus plan and reflects the School's vision to continue as a one-facility environment to enhance interdisciplinary interaction and school cohesion. The plan that emerged tested a variety of ways to add the required 18,000 net square feet of space while phasing upgrades to the existing building.

**CHALLENGE**

Currently housed in 63,000 net square feet in a building initially built in the 1950s and added to in the 1980s, the school's growing research programs had nowhere to expand and the project-based undergraduate curriculum was constrained by the building's obsolescence. The challenge was to develop an expansion and reuse scheme within one structure and within the confines of the existing site.

**SOLUTION**

The plan that emerged tested a variety of ways to add the required 35,000 net square feet of space while phasing upgrades to the existing building.

**RESULTS**

Fundraising was successful, and the project proceeded through design and construction following the concept that we developed with the School.

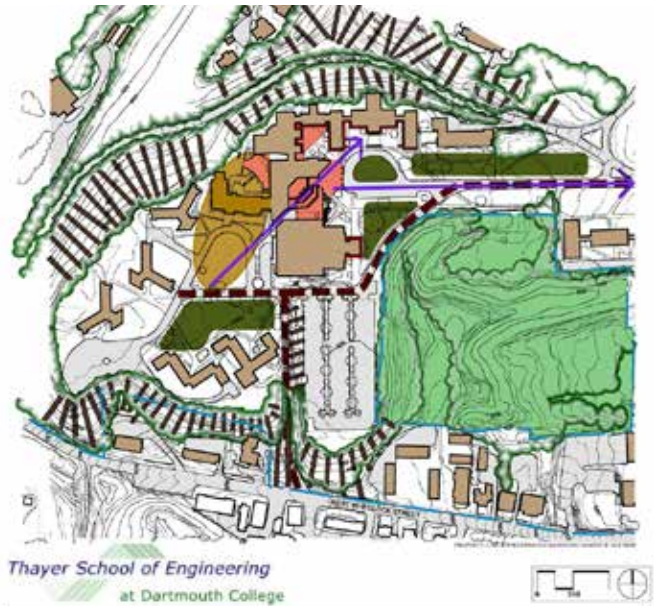

DESIGN FEATURES ANALYSIS DRAWING

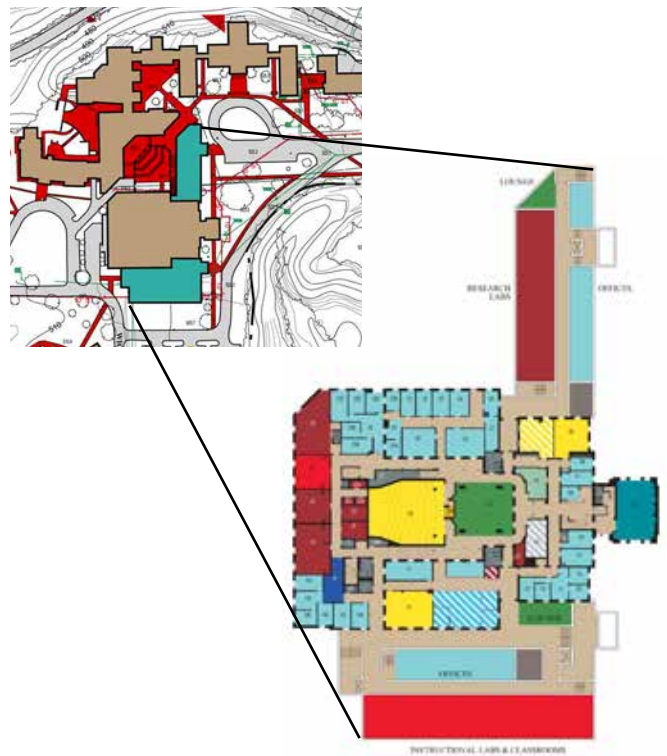

REUSE AND EXPANSION SCHEME



CUMMINGS-MACLEAN  
SOURCE: DARTMOUTH COLLEGE

\*Project completed under previous name: Dober, Lidsky, Craig and Associates, Inc.

**REFERENCE**

Lawrence W. McKinnon  
Senior Executive Officer  
Thayer School of Engineering  
603 646 1582  
lawrence.w.mckinnon@dartmouth.edu

**PRINCIPAL IN-CHARGE**

Arthur J. Lidsky, AICP, FAAAS  
Study Director  
  
George G. Mathey, AICP  
Study Coordinator



**DOBER LIDSKY MATHEY**  
CREATING CAMPUS SOLUTIONS